

MICROCOM CORPORATION

MODEL 405

BATTERY POWERED DIRECT THERMAL PRINTER

ADDENDUM

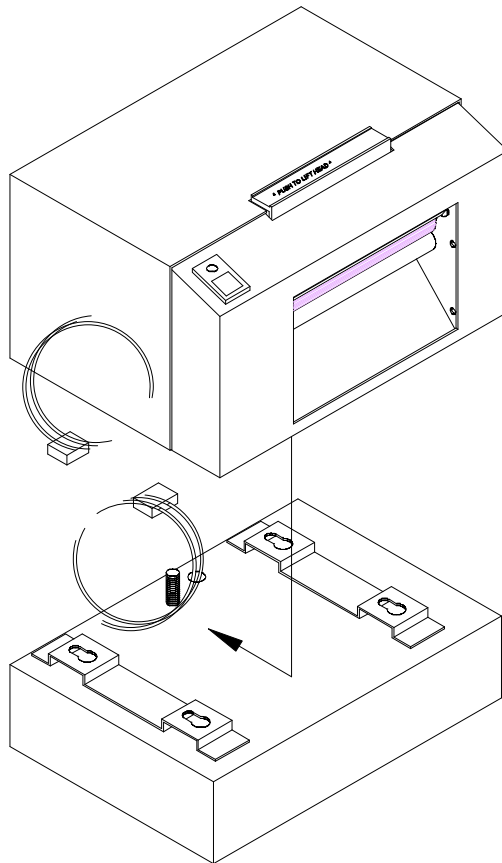

June 1994

Software Version 3.0

Model 405 Addendum

1.1 SPECIAL FEATURES

- ! Over 10,000 linear inches of average density print from a single charge.
- ! Recharges completely in 14 hours. (reaches 90% charge in 10 hours)
- ! Removable battery pack increases printer height by only 2.25 inches.
- ! Uses common 6 volt lead acid batteries which are internally recharged when the printer is connected to standard AC power.

1.2 CONNECTING THE 405 PRINTER AND BATTERY PACK

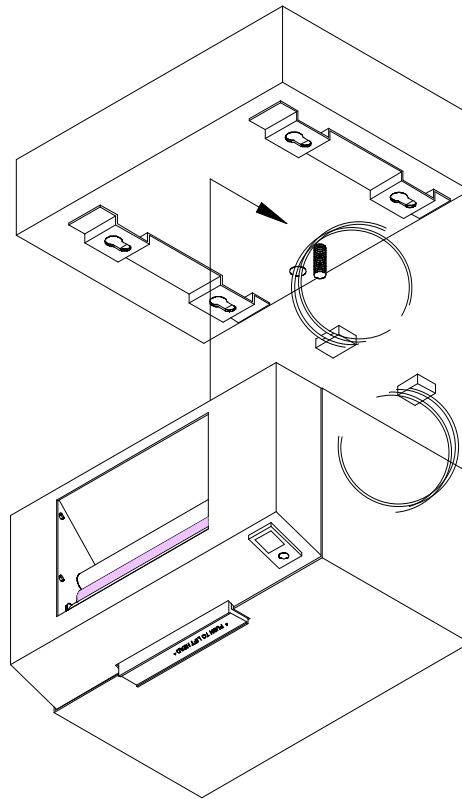

1. Remove the battery pack and printer from the packing material.
2. Turn the printer upside down and set it on a soft surface.
3. Connect the power output from the battery pack to the printers input cable.
4. Pull the large screw on the battery pack while sliding the pack onto the printer.
5. Once the battery pack is fully locked into position, tighten the large screw.
6. Verify that the connecting cable is not protruding from the rear of the printer.

1.3 SPECIAL STATUS LIGHT/TONE INFORMATION

The status light has different functions depending upon the mode of the printer. Table 1 shows the relationship between the status light and the different modes.

Status Light/Tone			
Light Color	Tone	Mode	Meaning
Green	None	All	On-Line and ready to print
Green	Double tone before print	All	Battery is low, recharge the printer. At this point the battery is at approximately 10% of its capacity and can print less than 1000 additional linear inches.
Red	None	All	Printer error: Caused by a paper-out condition or a hardware failure. If paper is out, follow instructions in section 2.3, otherwise turn printer off and back on. If condition persists, contact your service representative.
Flashing Red	Continuous Tone	All	The battery pack is too low for proper printer operation. The unit will remain in this mode until the battery is recharged or the printer is powered off.
Yellow	None	Tag/tear, Peel	Label present. Label is ready to be removed from the printer mouth.
Flashing Yellow	None	Batch	Printer is in standby mode and waiting for the front panel button to be pressed.
Flashing Yellow	None	After Paper-Out	Printer is waiting to continue processing. The label button must be pushed twice to clear yellow after loading.

Table 1